

Plan Information

Tenure Type	Freshhold
Plan Type	Deposited Plan
Plan Purpose	Subdivision

Plan Heading

LOTS 302-305 AND ROAD

Locality and Local Government

Locality	MOUNT HELENA
Local Government	SHIRE OF MUNDARING

Planning Approval

Planning Authority	Western Australian Planning Commission
Reference	160098

Roads

New Road or Extension (Road Name Approval) | Yes

Road Name

Road Name	MCCARTHY ROAD
Locality	MOUNT HELENA

Survey Details

Survey Method	Conventional Survey
Field Records	155718
Declared as Special Survey Area	No

Survey Certificate – Regulation 54

I hereby certify that this plan is accurate and is a correct representation of the ---
 (a) survey and/or
 (b) survey and/or non measurements recorded in the field records,
 (c) delete if inapplicable
 undertaken for the purposes of this plan and that it complies with the relevant written
 law(s) in relation to which it is lodged.

Aaron P. Gibson

Aaron P. Gibson
 2023.04.19 10:02:52 +08:00

AARON PETER GIBSON
 Licensed Surveyor

Survey Organisation

Name	DE NADA ENGINEERING AND LAND SURVEYS
Address	BALCATTA 6021
Phone	08 93448885
Fax	08 93448889
Email	solutions@denada.net.au
Reference	23024

Former Tenure

New Lot / Land	Parent Plan Number	Parent Lot Number	Title Reference	Parent Subject Land Description
302-305	DP222834	LOT 117	1609-579	

New Memorials and Notifications

Subject	Purpose	Statutory Reference	Origin	Land Burdened	Benefit To	Comments
	NOTIFICATION (Hazards or Other Factors)	SEC. 185 OF THE P&D ACT 2005	DOC P570660	LOT(S) 302-305		BAL Rating
	NOTIFICATION (Hazards or Other Factors)	SEC. 185 OF THE P&D ACT 2005	DOC P570661	LOT(S) 302-305		Mosquito Warning
	NOTIFICATION (Factors Affecting Use or Enjoyment of Land)	SEC. 70A OF THE TLA 1893	DOC P570659	LOT(S) 302-305		No recalculated sewerage



ADDITIONAL SHEETS
ENDORSEMENT SHEET

SHEET
1 OF 2

VERSION NUMBER
1

DEPOSITED PLAN
422170

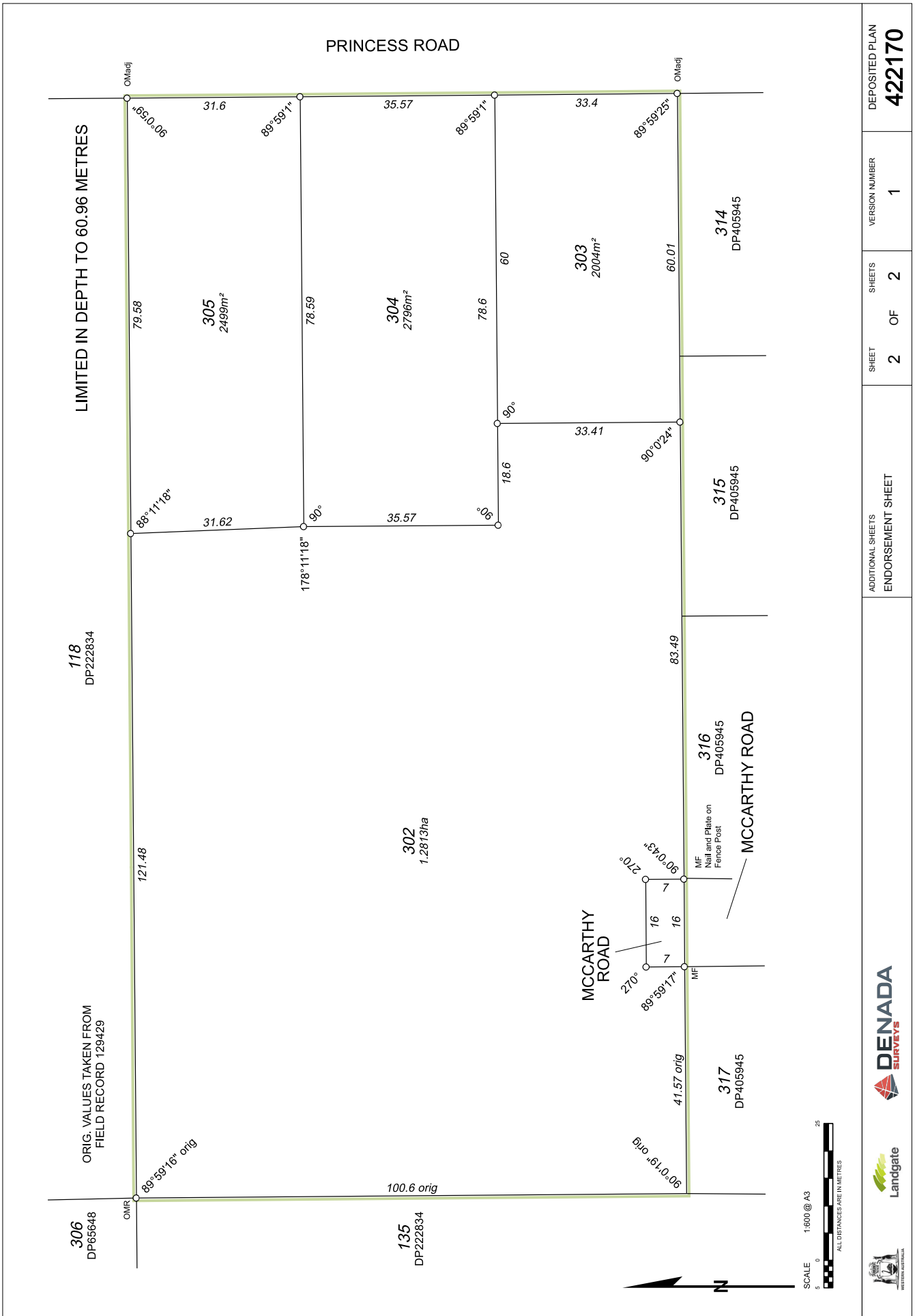

DEPOSITED PLAN	422170
VERSION NUMBER	1
SHEETS	2 OF 2
ADDITIONAL SHEETS	ENDORSEMENT SHEET

306 DP65648

118 DP222834

178°11'18"

88°11'18"

79.58

31.62

305 2499m²

31.6

89°59'11"

35.57

304 2796m²

78.59

35.57

89°59'11"

78.6

90°

18.6

33.41

90°0'24"

303 2004m²

60

60.01

89°59'25"

314 DP405945

315 DP405945

316 DP405945

317 DP405945

302 1.2813ha

121.48

100.6 orig

41.57 orig

69°0'19" orig

16

16

270°

89°59'17"

270°

90°0'43"

MF Nail and Plate on Fence Post

MCCARTHY ROAD

MCCARTHY ROAD

OMadaj

OMadaj

ORIG. VALUES TAKEN FROM FIELD RECORD 129429

178°11'18"

89°59'16" orig

121.48

100.6 orig

41.57 orig

69°0'19" orig

16

16

270°

89°59'17"

270°

90°0'43"

MF Nail and Plate on Fence Post

MCCARTHY ROAD

MCCARTHY ROAD

OMadaj

OMadaj

SCALE 1:600 @ A3

0 10 20

ALL DISTANCES ARE IN METRES

N

Lodgement and Examination

Lodgement Date	21/04/2023
Examination Date	21/04/2023

Western Australian Planning Commission

Planning Approval	Yes
Reference	160898

01-May-2023

Delegate under S. 16 P&D Act 2005 | Date

In Order For Dealings

Subject To	<ul style="list-style-type: none">• Section 168(1)(2) of the P&D Act• Section 165 of the P&D Act 2005• Section 70A of the TLA 1993
------------	--

For Inspector of Plans and Surveys / Authorised Land Officers | Date

8.5.2023

Plan Approved

Inspector of Plans and Surveys / Authorised Land Officer | Date

31.5.2023



ENDORSEMENT SHEET

VERSION NUMBER

1

DEPOSITED PLAN
422170